

# DOUBLE-HUNG

WALL SECTIONS

## RENAISSANCE SERIES STUCCO

NOTE:  
SEE FLASHING DETAIL  
SHEETS FOR RECOMMENDED  
HEAD, JAMB, AND SILL  
FLASHING PROCEDURES

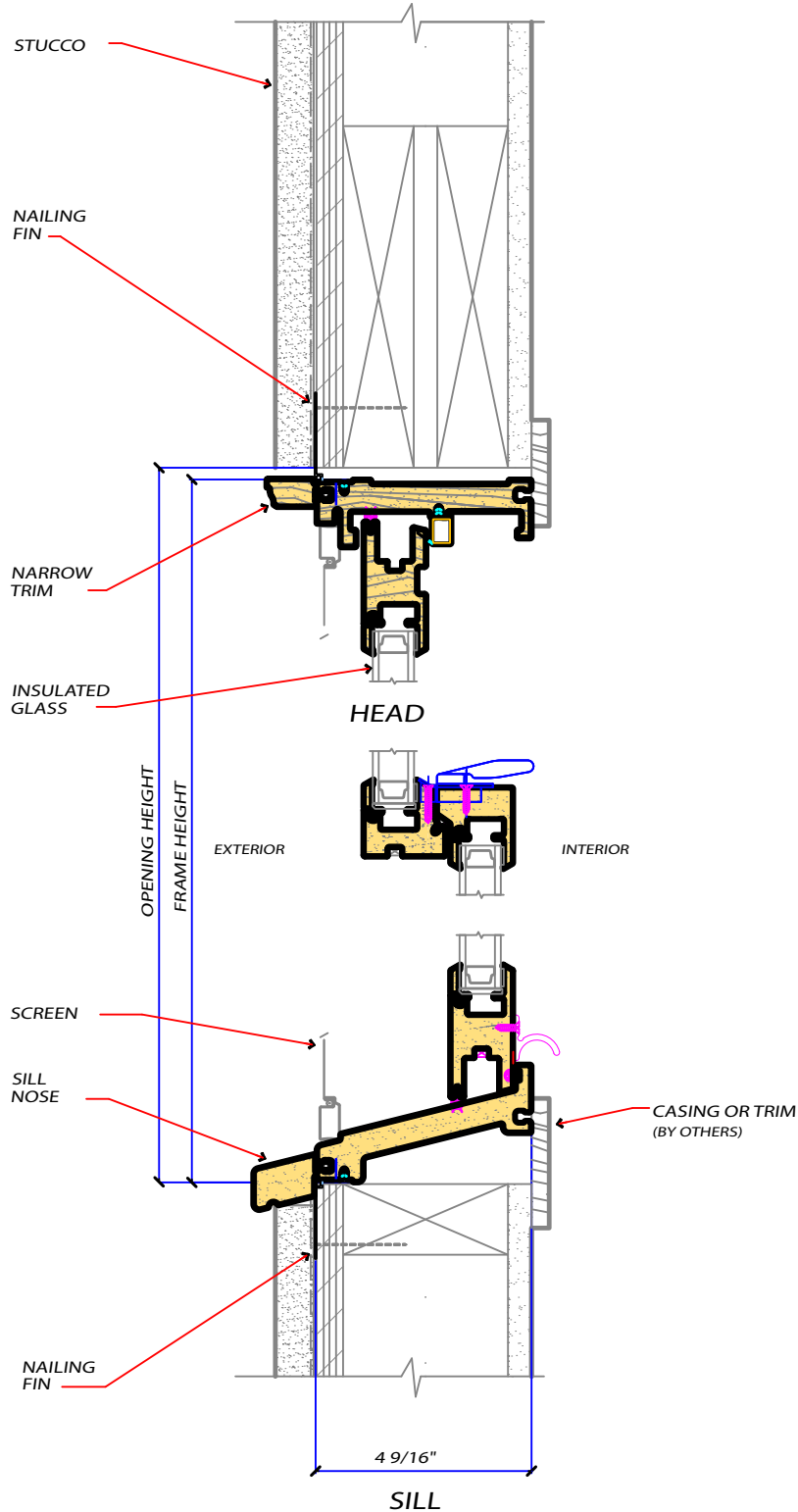

### VERTICAL SECTION

SCALE 3" = 1'-0"