



# PICTURE SASH & FRAME

WALL SECTIONS

## ARTISAN SERIES STUCCO

NOTE:  
FOLLOW THE AMSCO INSTALLATION AND  
FLASHING GUIDELINES RECOMMENDED  
FOR PROPER HEAD, JAMB AND SILL  
FLASHING PROCEDURES

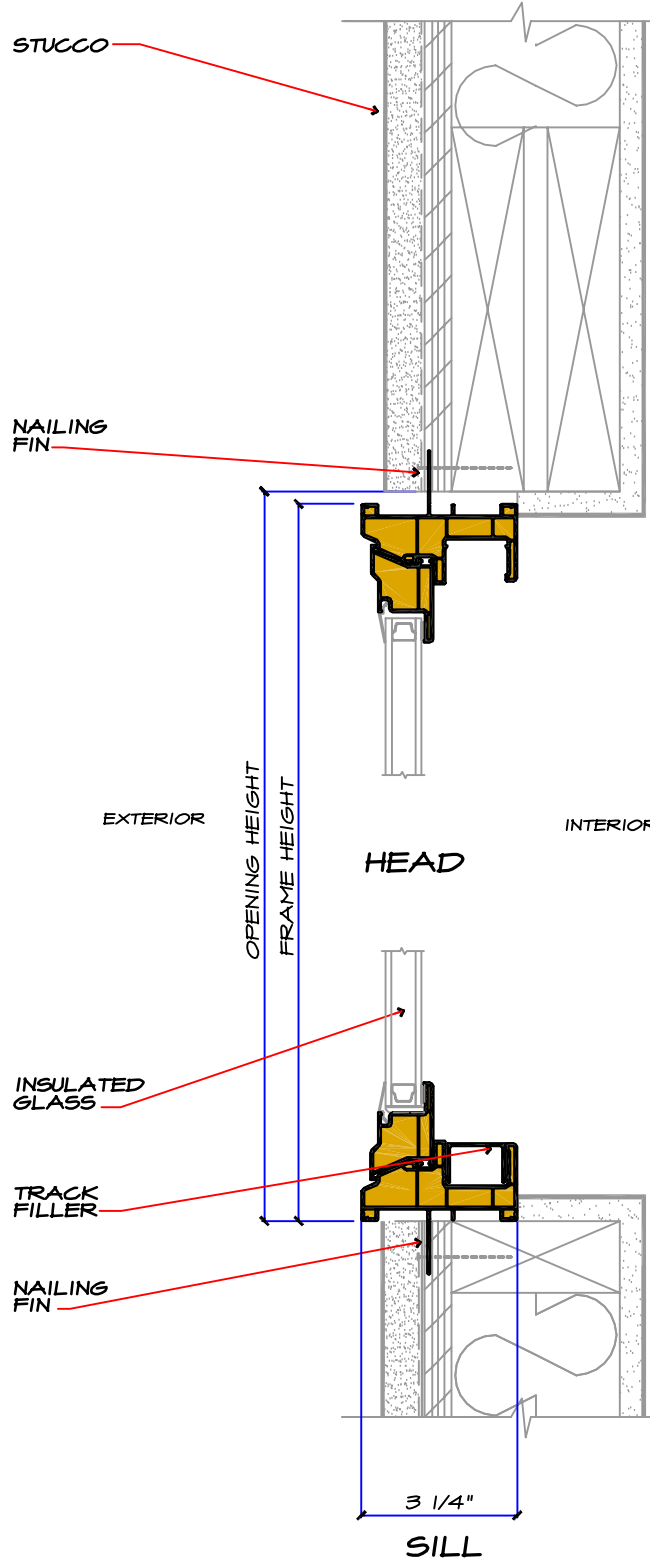

VERTICAL SECTION  
SCALE 3" = 1'-0"