



# HORIZONTAL SLIDER

WALL SECTIONS

## ARTISAN SERIES SIDING

NOTE:  
FOLLOW THE AMSCO INSTALLATION AND  
FLASHING GUIDELINES RECOMMENDED  
FOR PROPER HEAD, JAMB AND SILL  
FLASHING PROCEDURES

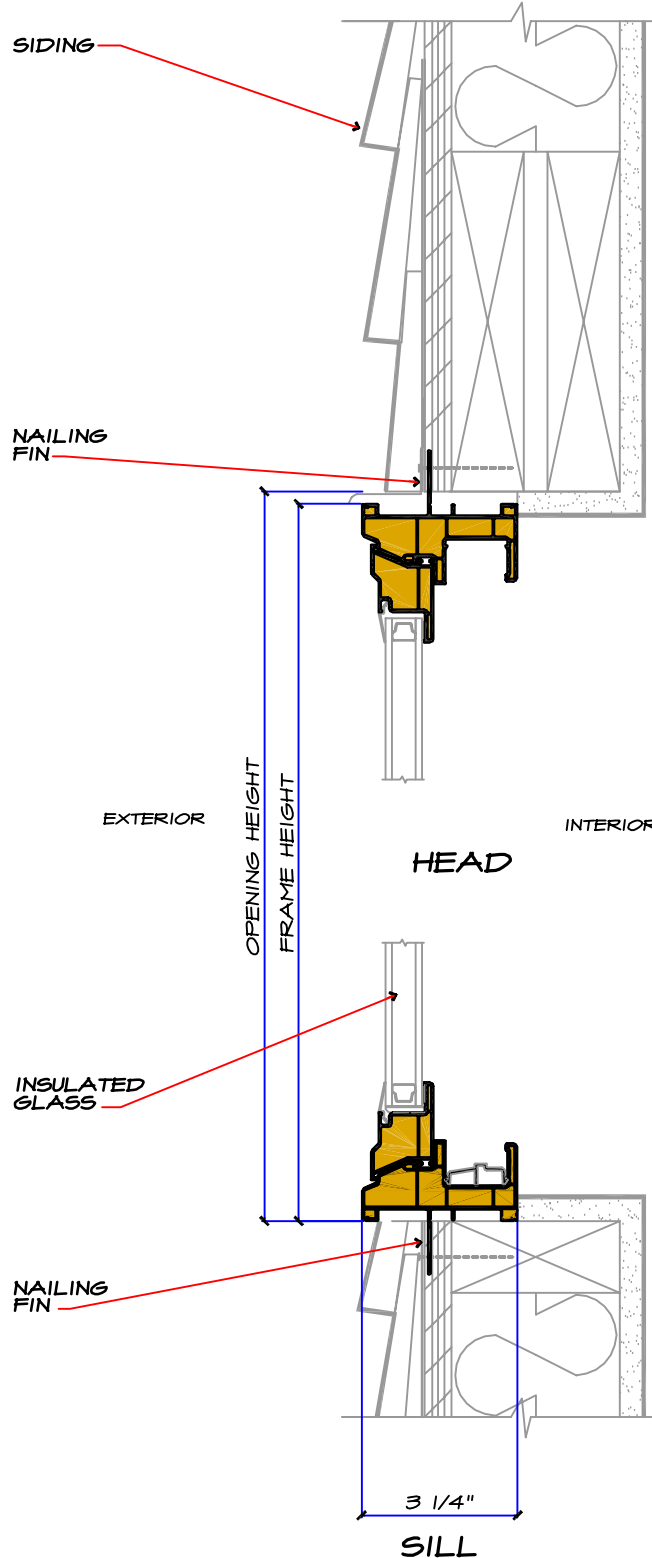

## VERTICAL SECTION

SCALE 3" = 1'-0"